

DRAWING DESIGNED TO BE PRINTED ON 8 1/2"X14" PAPER

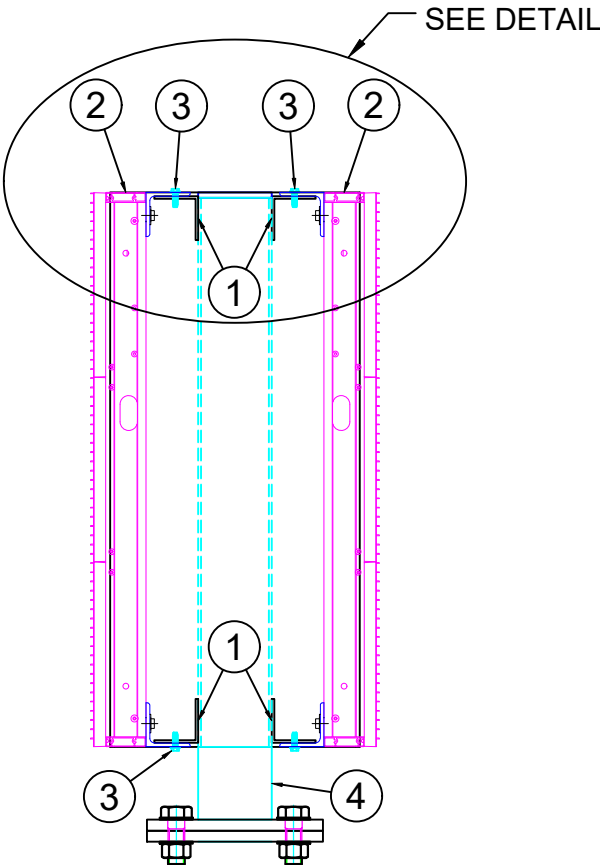

MOUNTING ANGLES DETAIL

NOT TO SCALE

- 1. STEEL ANGLE, WELDED TO STEEL TUBE
- 2. ATLAS LED CABINET
- 3. FASTENER
- 4. STEEL TUBE, A500 GRADE B

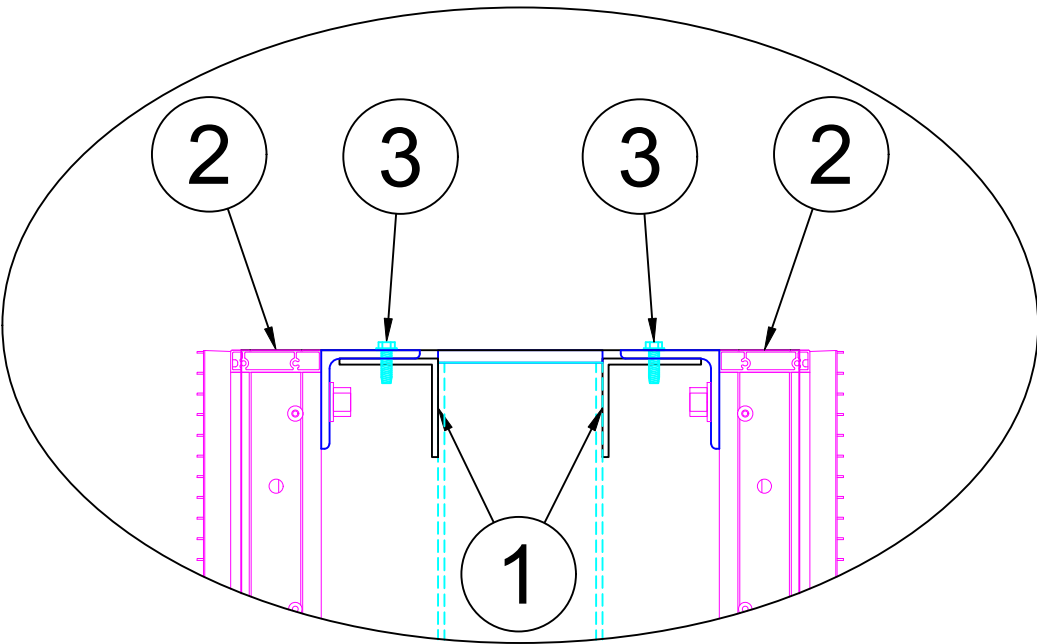

DETAIL

DRAWING DESIGNED TO BE PRINTED ON 8 1/2"X14" PAPER

<div> <small>2201 CANTU COURT, SUITE 215 SARASOTA, FL 34232 PH. 1-800-237-3928 FAX 1-800-485-4280</small></div>	<div>Date:04-24-25 Drawn by: JRM</div>	S.S. TEMPLATE MUST BE USED TO SET THREADED RODS INTO CONCRETE			Sign Model: ATLAS COLOR 6.67mm 192x336	Page 3 OF 7
	REVISION	DESCRIPTION	Drawing #:	Sketch #:	Customer #:	Customer Name:
			ATLAS-6.67mm-C-192x336	1057942-8a-s	3202326	SHORE BUILDERS GROUP
						Customer Address:
						287 WEST 8TH ST BEACH HAVEN, NJ 08008

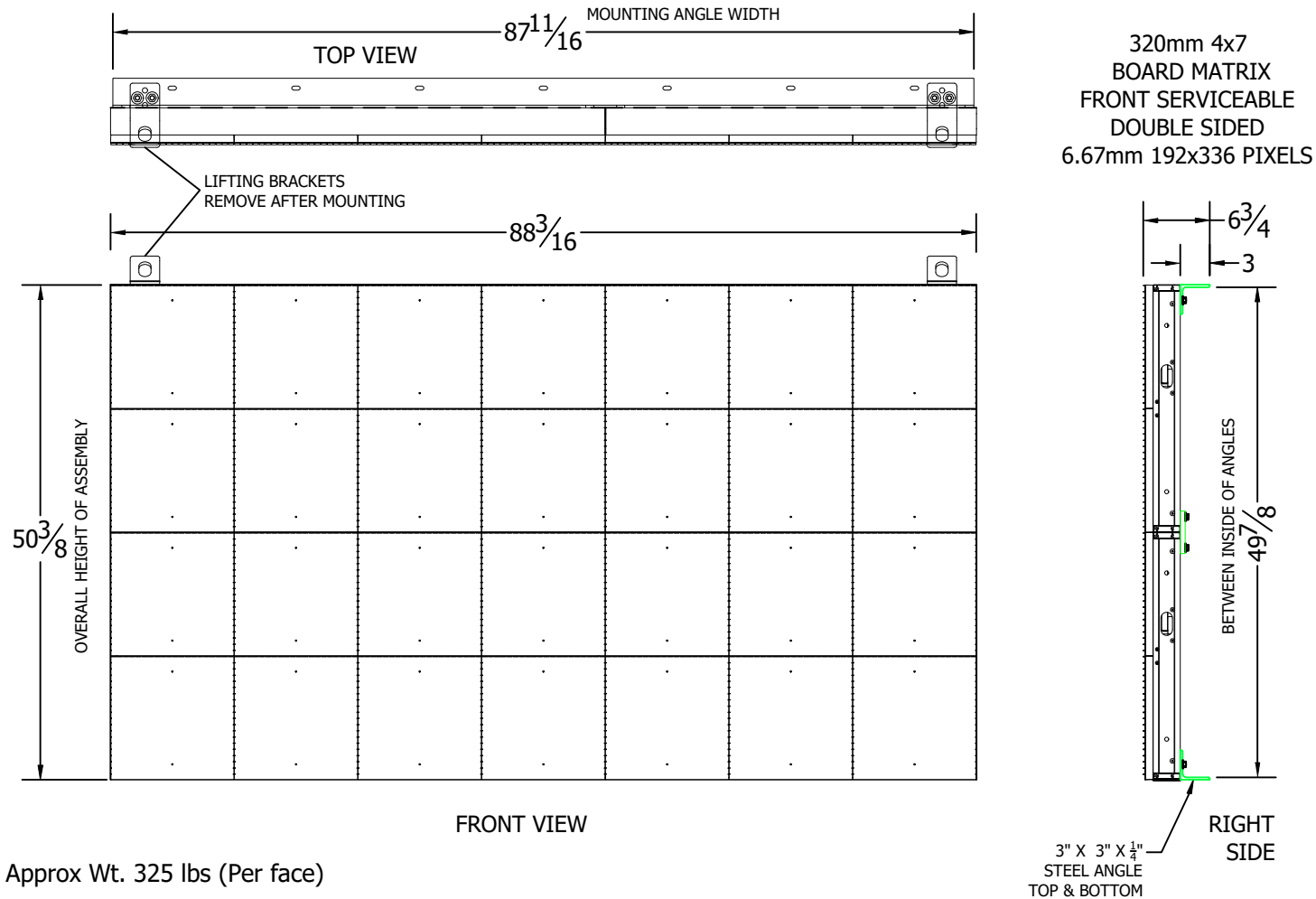

GENERAL NOTES

1. EXTERIOR OF DISPLAY FINISHED MATTE BLACK.
2. ANY FEATURES NOT DIMENSIONED ARE NOT CRITICAL TO DESIGN OF SECONDARY STRUCTURES.
3. LOCATION OF CONDUIT FITTINGS, VENTILATION INTAKES, VENTILATION EXHAUSTS AND PICK POINTS SUBJECT TO CHANGE DUE TO DETAILED DESIGN CONSIDERATIONS AND CUSTOMER REQUEST.
4. THE MOUNTING ANGLES ON REAR OF DISPLAY ARE THE SOLE LOAD BEARING COMPONENT OF THE DISPLAY. DO NOT USE PICK POINTS OR ANY OTHER AREAS OF THE DISPLAY FOR SUPPORTING THE COMPLETED DISPLAY.
5. ALL INSTALLATIONS, SUPERSTRUCTURES DESIGNS AND CONNECTIONS MUST BE DESIGNED/APPROVED BY A QUALIFIED ENGINEER.
6. DISPLAY IS REAR VENTILATED. TO MAINTAIN WARRANTY COVERAGE, AIR MUST BE ALLOWED TO FLOW UNOBSTRUCTED FROM ALL AIR VENTS. **MAINTAIN A MINIMUM OF 3" BETWEEN REAR OF DISPLAY AND WALLS**
7. AIR DUCTS OR UNOBSTRUCTED SPACES THAT ALLOW AIR TO FLOW BEHIND THE DISPLAY MUST BE INCORPORATED IN THE DESIGN, INCLUDING BUT NOT LIMITED TO SPACES AROUND PERIMETER OF DISPLAY FACE OR CHANNELS THROUGH THE MOUNTING STRUCTURE. RECOMMENDED MINIMUM OF 2 INCHES VENTILATION CLEARANCE AROUND ALL EDGES OF DISPLAY IF BEING MOUNTED ABOVE/BELOW OTHER SIGNAGE OR STRUCTURES.
8. TO MAINTAIN INGRESS PROTECTION RATING (IP RATING) THE DISPLAY CABINET IS NOT TO BE MODIFIED IN ANY MANNER, INCLUDING DRILLING HOLES OR SECURING OTHER MATERIALS DIRECTLY TO THE DISPLAY CABINET.
9. UNSECURED DISPLAYS ARE NOT STABLE. ALWAYS SECURE BOTH CRATED AND NON-CRATED DISPLAYS TO PREVENT ACCIDENTAL TIPPING BY WIND OR OTHER FORCES. NEVER OPEN ANY SERVICE PANEL OF A DISPLAY UNLESS THE DISPLAY IS SECURED FROM TIPPING.
10. DESIGN AND DIMENSIONS ARE SUBJECT TO CHANGE WITHOUT NOTICE.

UNLESS OTHERWISE SPECIFIED DIMENSIONS ARE IN INCHES
TOLERANCES: $\frac{1}{16}$ "

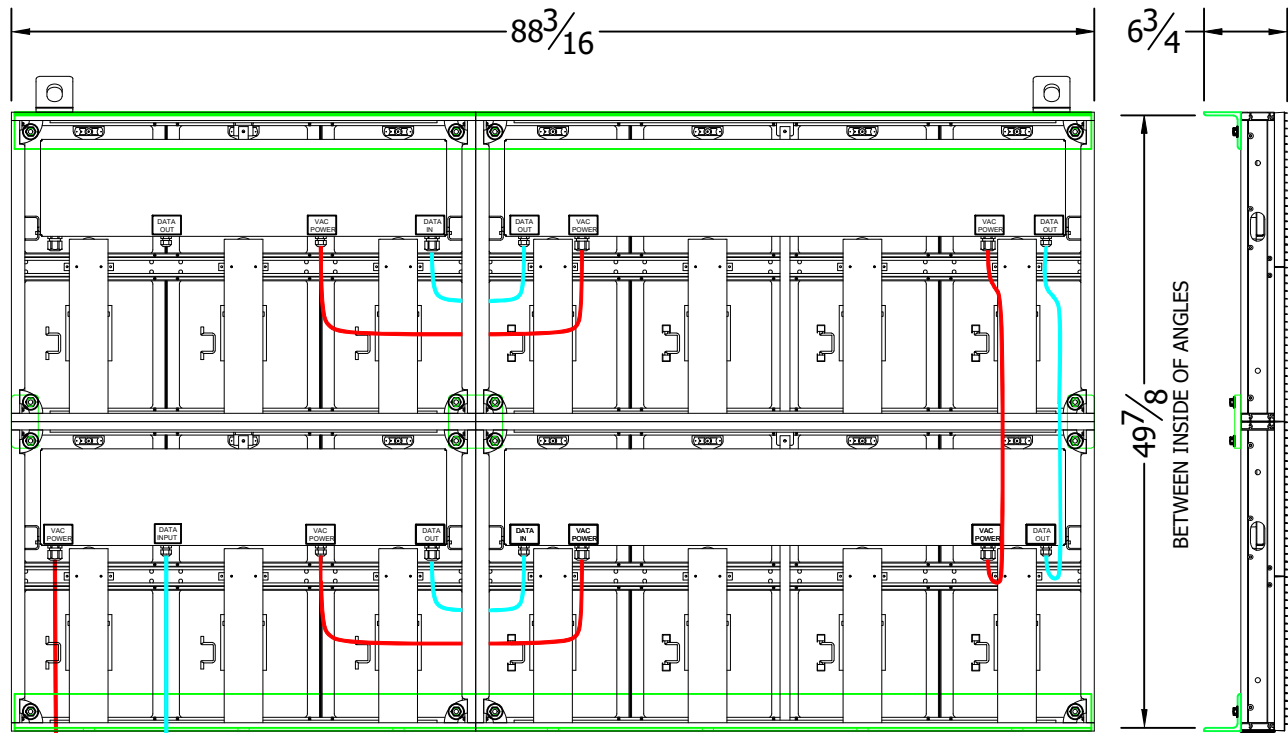

Ethernet Cable
Data Input From
Control Cabinet

240VAC
Power In
Pig Tail #1
Circuit #1

**PARENT
REAR VIEW**

END VIEW

ATLAS 6.67mm LED FRONT SERVICE DISPLAY
Color RGB/Pixel, Matrix 192x336 Pixels
Single Sided
POWER REQUIREMENTS / DISPLAY:
9.4FLA each / 240VAC
Qty1 20A 240VAC Circuit Required

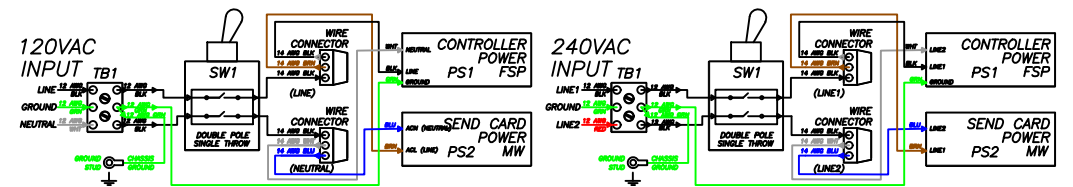
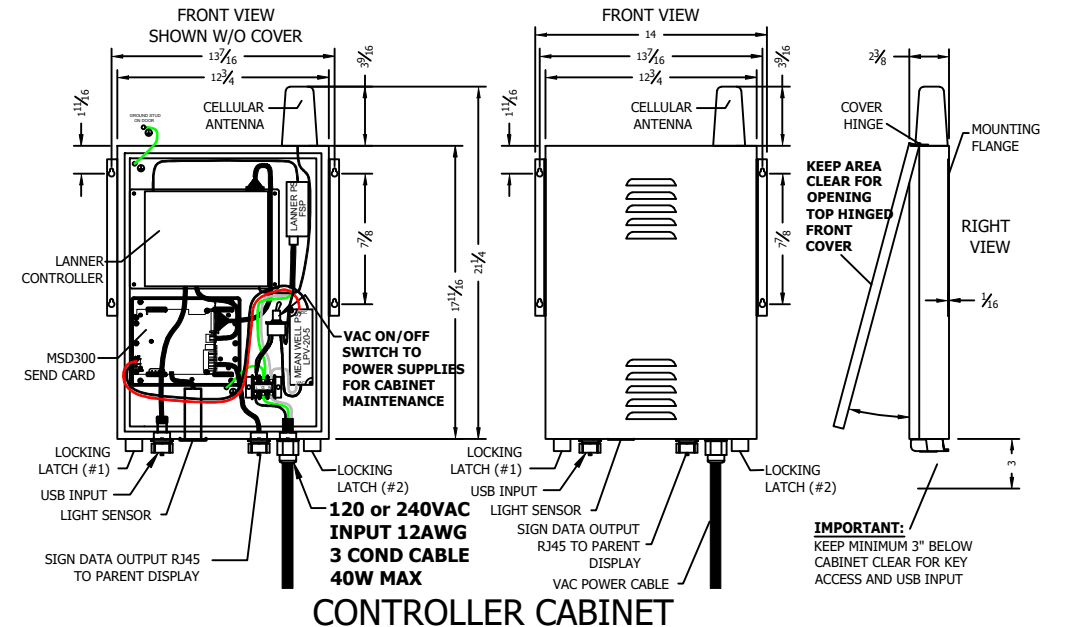

VAC INPUT SCHEMATICS

DRAWING DESIGNED TO BE PRINTED ON 8 1/2"X14" PAPER



2201 CANTU COURT, SUITE 215 SARASOTA, FL 34232
PH. 1-800-237-3928 FAX 1-800-485-4280

Date:04-24-25
Drawn by: JRM

REVISION DESCRIPTION

S.S. TEMPLATE MUST BE USED TO SET THREADED RODS INTO CONCRETE

Drawing #:

ATLAS-6.67mm-C-192x336

Sketch #:

1057942-8a-s

Customer #:

3202326

Customer Name:

SHORE BUILDERS GROUP

Sign Model:

ATLAS COLOR 6.67mm 192x336

Page

5 OF 7

Customer Address:

287 WEST 8TH ST
BEACH HAVEN, NJ 08008

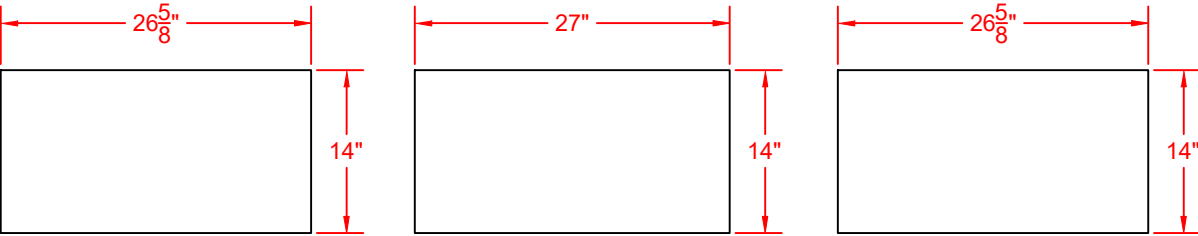

SOLID TOP PANELS
QUANTITY: 1 EACH

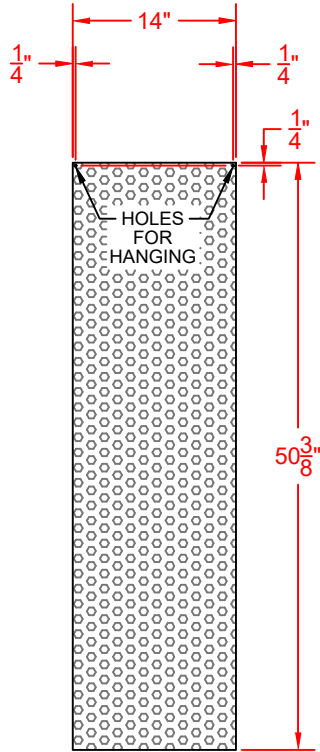

SIDE FILLER PANEL
QUANTITY: 2 EACH

**FILLER PANELS
TO BE ATTACHED
WITH SCREWS & RUBBER
WASHERS**

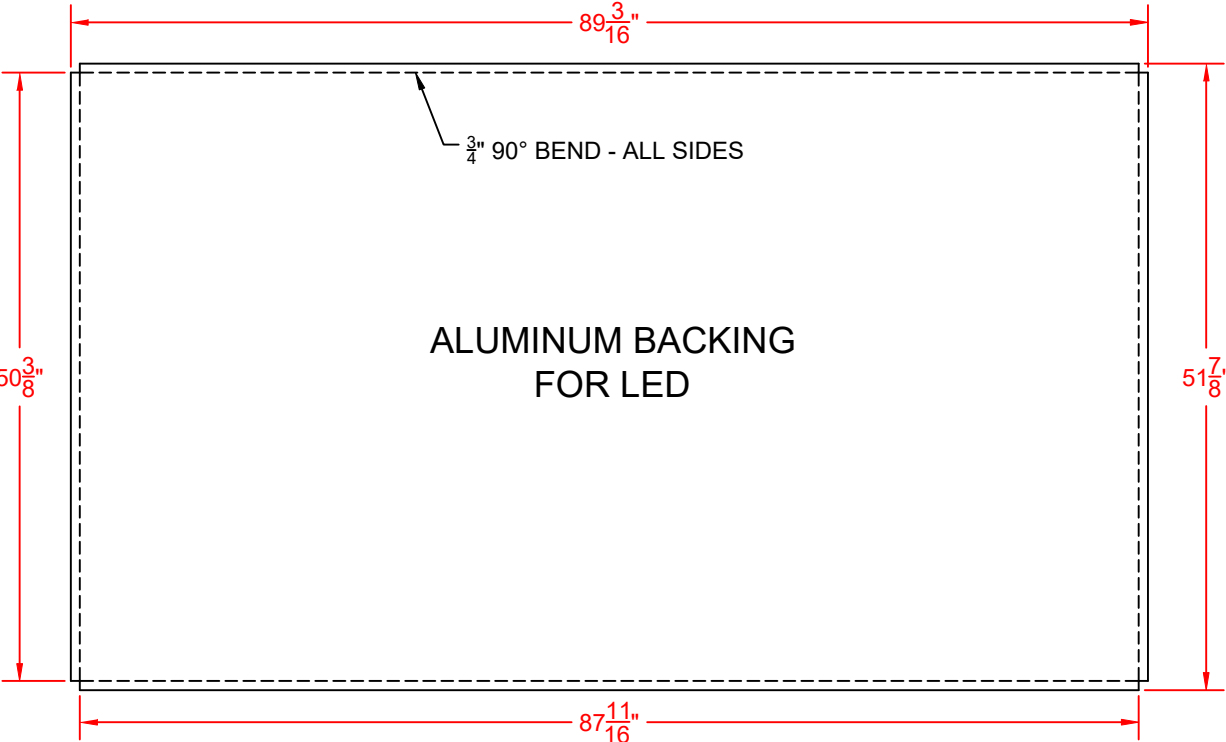

DRAWING DESIGNED TO BE PRINTED ON 8 1/2"X14" PAPER

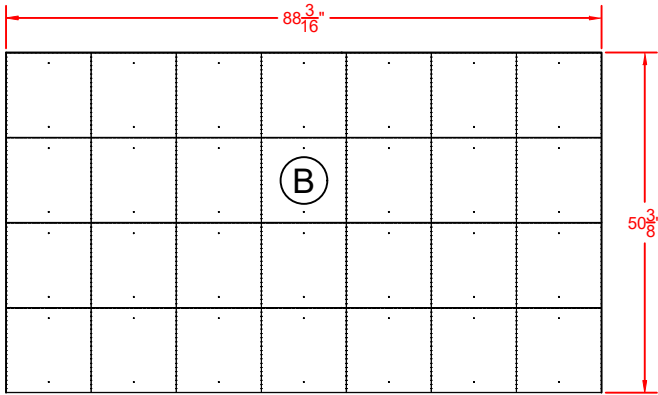

FACE DETAIL
NOT TO SCALE

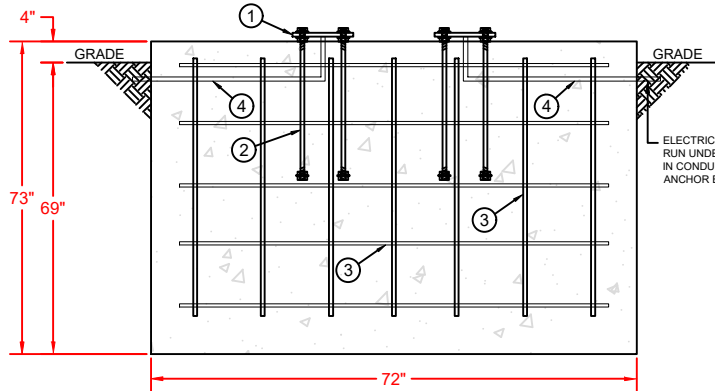

FOOTER - FRONT VIEW
NOT TO SCALE

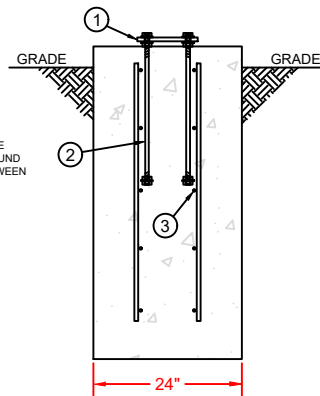

FOOTER - SIDE VIEW
NOT TO SCALE

FACE DETAIL

A. ATLAS LED

FOOTER DETAIL

- 12"X12"X1" CUSTOM STEEL BASE PLATES, 2 REQUIRED
- 1"X30" ANCHOR ROD, 8 REQUIRED
TAPE THE EXPOSED TOP OF THE THREADED RODS FOR PROTECTION AGAINST CONCRETE.
- #5 REBAR OR BETTER, TIED AT EACH JOINT.
SUPPLIED BY THE CUSTOMER
- CONDUIT, SUPPLIED BY THE CUSTOMER

NOTES

- THIS DESIGN IS PROTOTYPICAL AND SHOULD NOT BE USED FOR SITE SPECIFIC APPLICATIONS UNLESS REVIEWED AND DEEMED SUITABLE FOR USE AT THAT SITE BY A COMPETENT PROFESSIONAL ENGINEER.
- DESIGNED FACTOR MEETS OR EXCEEDS 130 MPH WIND LOAD, EXPOSURE C.
- 3,000 PSI CONCRETE - LESS THAN 3 CUBIC YARDS NECESSARY

ELECTRICAL INFO

- REQUIRES (1) 20 AMP CIRCUIT, 240 VOLTS, MAX DRAW 10 AMPS PER CIRCUIT
- ATLAS DISPLAYS ARE ETL LISTED - 5000314
- SIGNS SHALL BE GROUNDED BY CONNECTION TO THE EQUIPMENT GROUNDING CONDUCTOR OF THE SUPPLY BRANCH CIRCUIT.
- LED COMMUNICATION METHOD: WIRELESS DATA MODEM

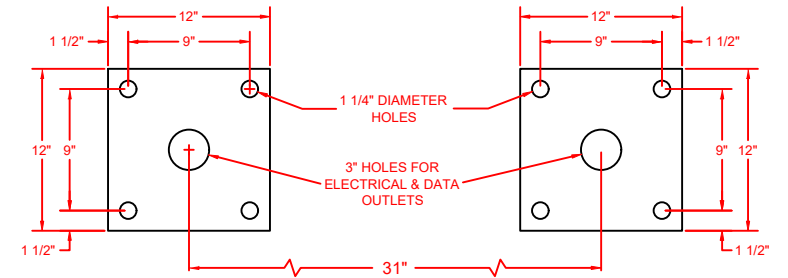

BASE PLATE DETAIL
NOT TO SCALE

DATA CABLE (IF APPLICABLE) MUST BE PLACED IN SEPARATE CONDUIT FROM ELECTRICAL

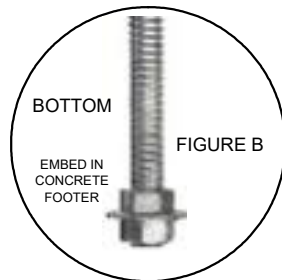
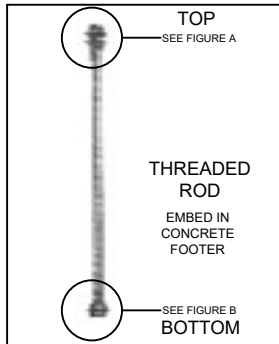
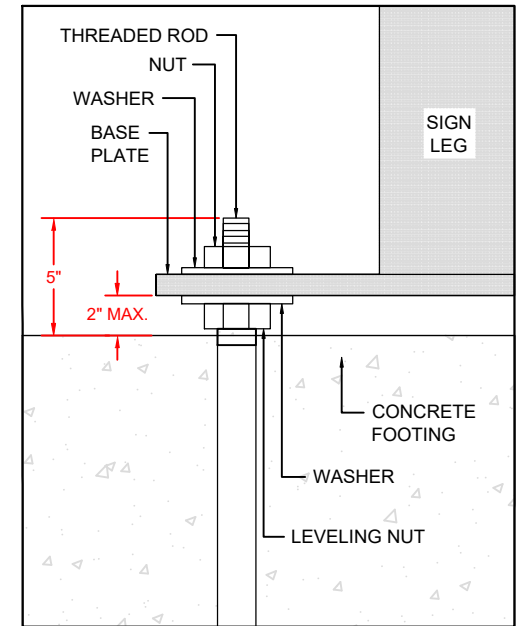

REVISION	DESCRIPTION

S.S. TEMPLATE MUST BE USED TO SET THREADED RODS INTO CONCRETE

Drawing #:

ATLAS-6.67mm-C-192x336

Sketch #:

1057942-8a-s

Customer #:

3202326

Customer Name:

SHORE BUILDERS GROUP

Sign Model:

ATLAS COLOR 6.67mm 192x336

Page

7 OF 7

Customer Address:

287 WEST 8TH ST
BEACH HAVEN, NJ 08008