

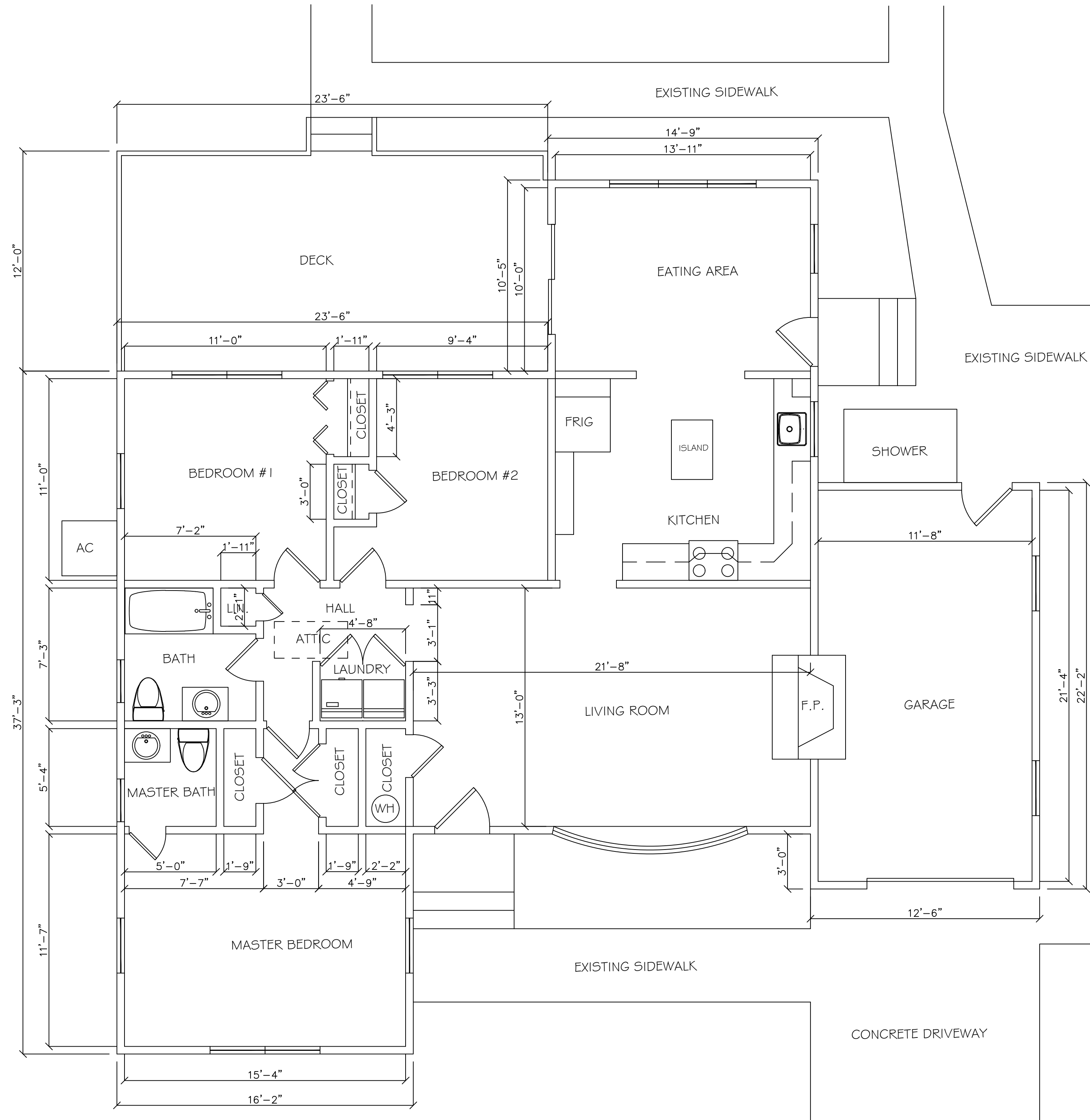

Know what's below.
Call before you dig.

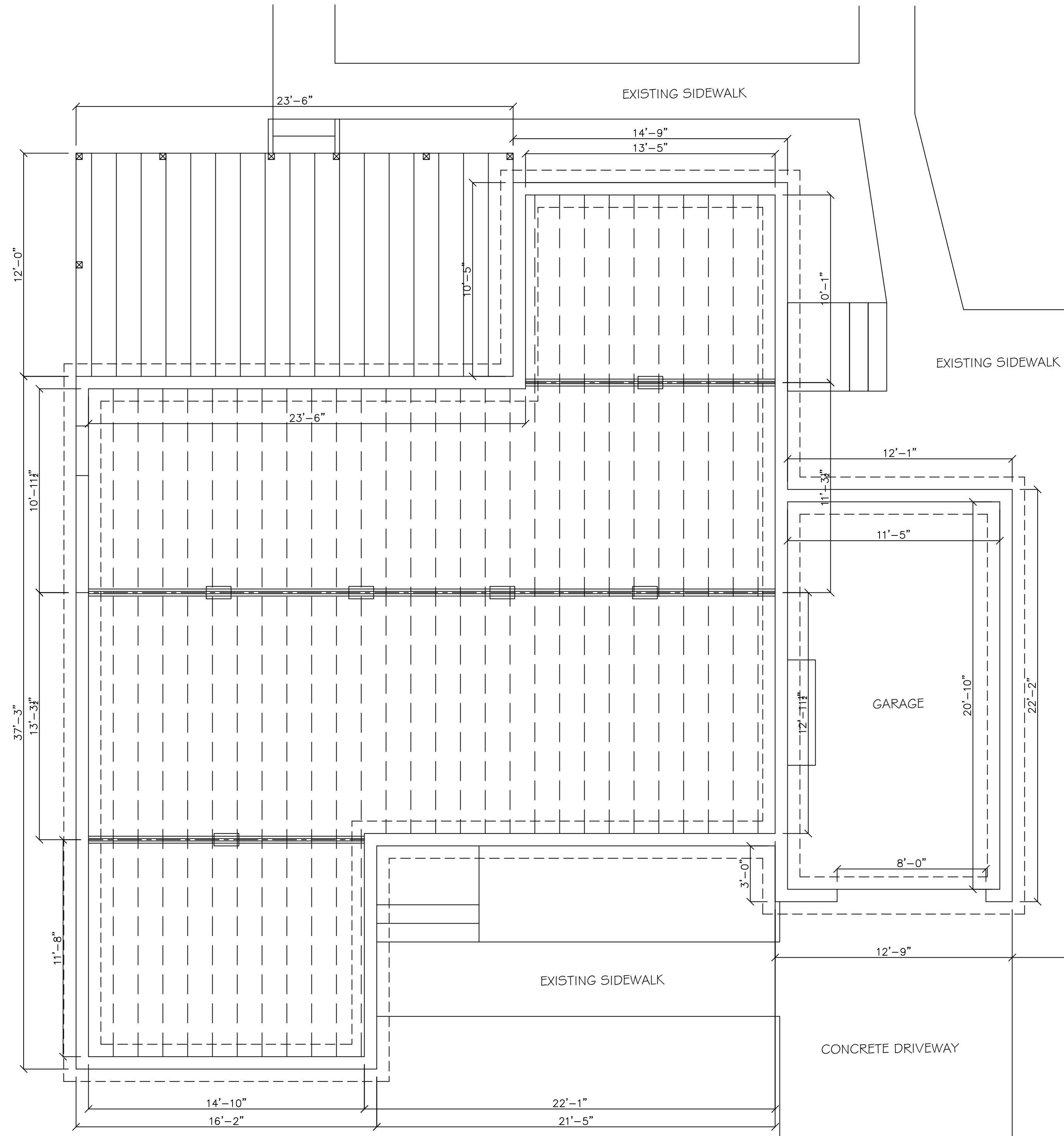

PROJECT #
85076J3759V07

PROJECT TITLE:
HOUSE ELEVATING AND ADDITION
JOHN & MARGARET LIHWARCIK
328 W. 11TH STREET
SHIP BOTTOM, NEW JERSEY 08008
LOT 6; BLOCK 90

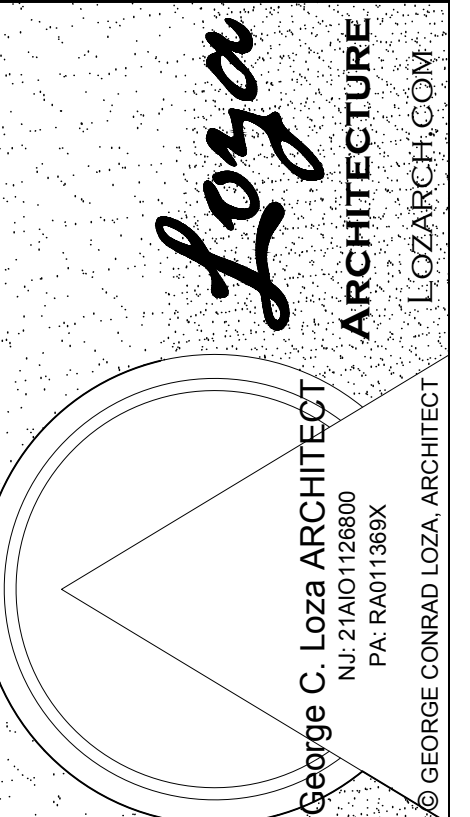

George C. Loza ARCHITECT
NJ 21A01126800
PA R4011981K
© GEORGE CONRAD LOZA, ARCHITECT

LOZA ARCHITECTURE
3219 W. BRIGANTINE AVENUE
BRIGANTINE, NJ 08203
OFFICE #: 609-266-3883

402 S. MAIN STREET
SPRING CITY, PA 19475
MOBILE #: 610-608-5013
GCLOZA@GMAIL.COM

GEORGE C. LOZA ARCHITECT
EXPRESSLY RESERVES HIS COMMON
PROPERTY RIGHTS IN THESE PLANS.
ALL DRAWINGS, SPECIFICATIONS,
AND COPIES THEREOF ARE, AND
WILL REMAIN, THE SOLE PROPERTY
OF GEORGE CONRAD LOZA. THEY ARE
TO BE USED ONLY WITH RESPECT TO
THIS PROJECT AND ARE NOT TO BE
REPRODUCED OR TRANSMITTED IN ANY
FORM OR BY ANY MEANS, ELECTRONIC
OR MECHANICAL, INCLUDING
PHOTOCOPYING, RECORDING, OR BY
ANY INFORMATION STORAGE AND
RETRIEVAL SYSTEM, WITHOUT THE
OBTAINING WRITTEN PERMISSION
AND CONSENT OF GEORGE C. LOZA.

DATE	REVISION

DATE ISSUED:
05 - 14 - 2020

SCALE:
1/4" = 1'-0"

SHEET TITLE:
EXISTING PLANS

SHEET #

A 3

SHEET 03 OF XX

CONTRACTOR SHALL VERIFY ALL
CONDITIONS AND DIMENSIONS AT THE SITE
BEFORE PROCEEDING WITH THE WORK.